

ELECTRICAL CIRCUITS

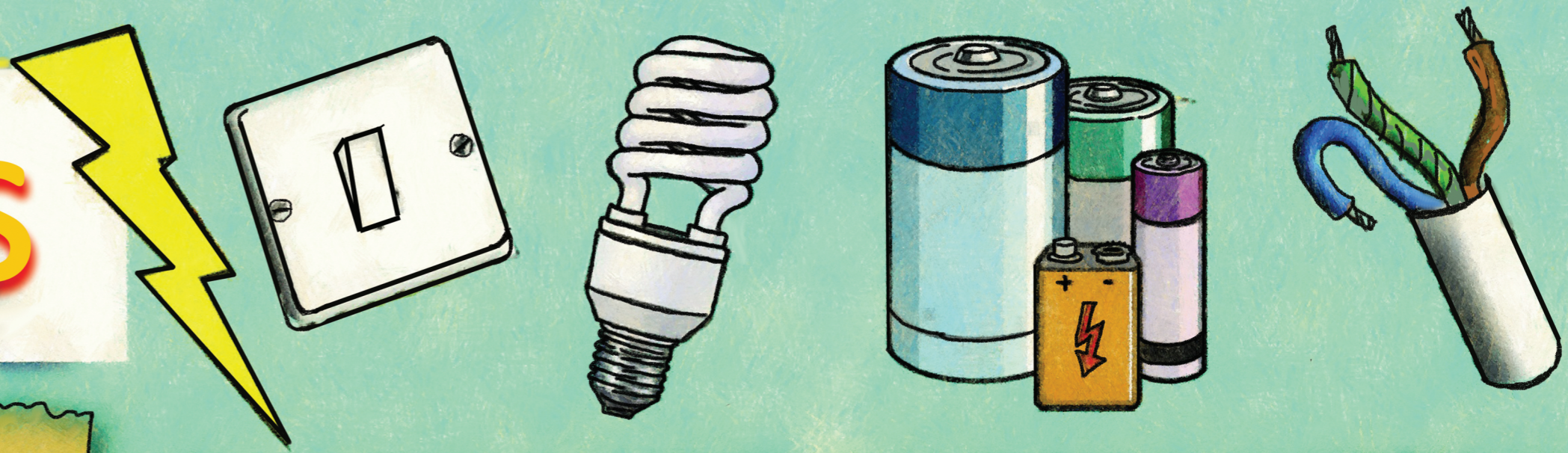

SIMPLE CIRCUITS

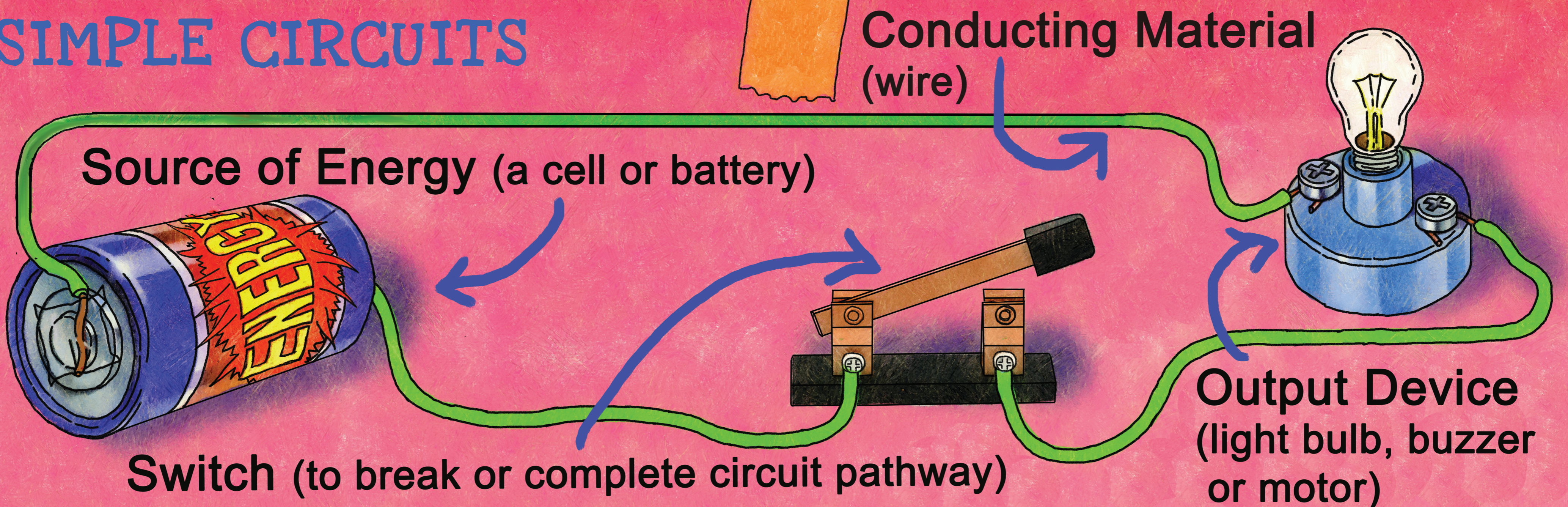

INSULATORS

Electrical energy cannot run through these materials.



Rubber Bands

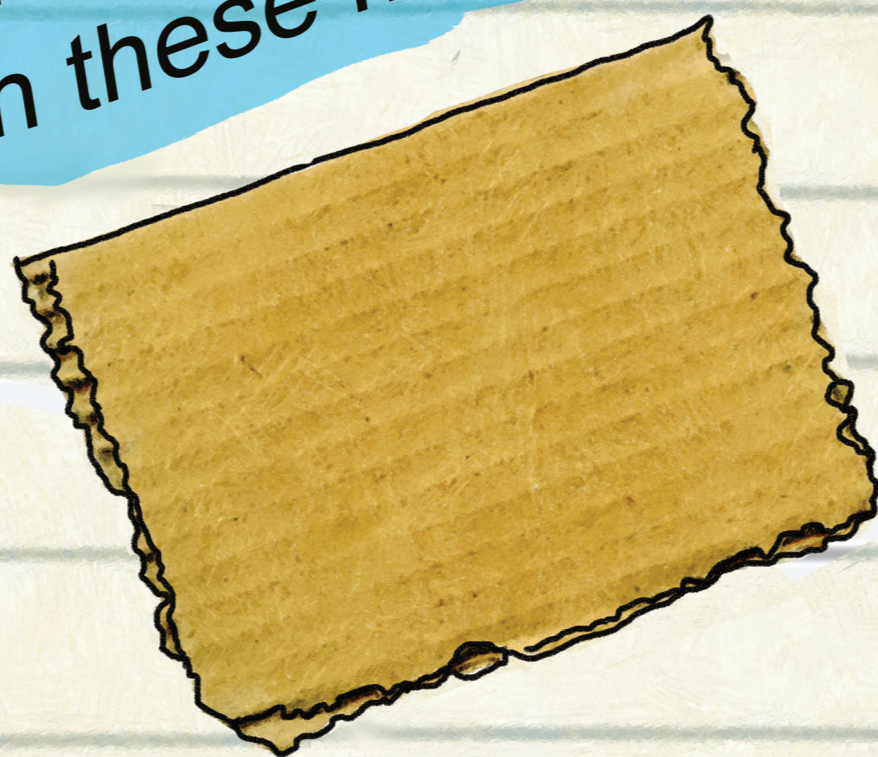

Cardboard

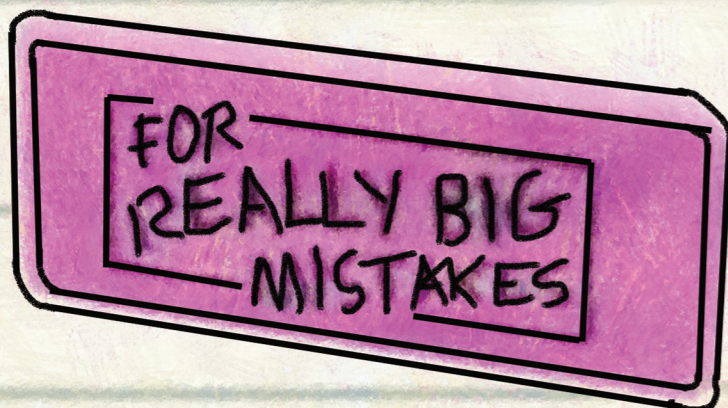

Eraser

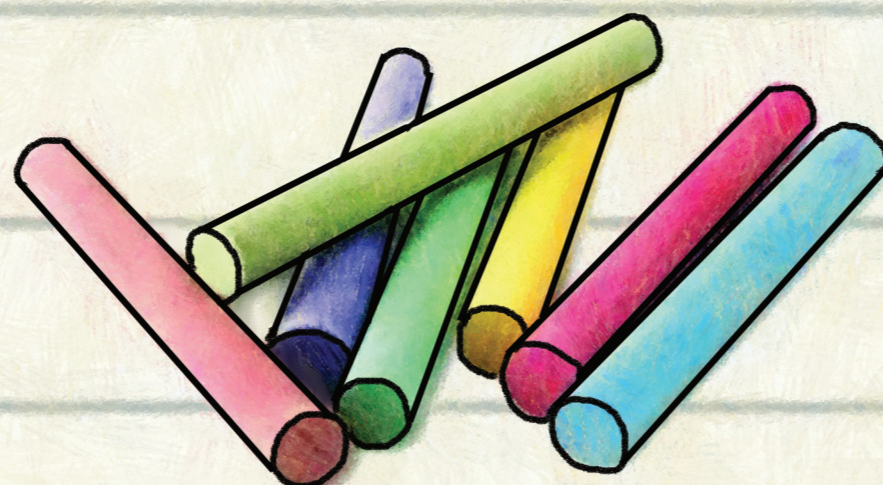

Chalk

CONDUCTORS

Electrical energy can flow through these materials.



Keys



Paper Clips

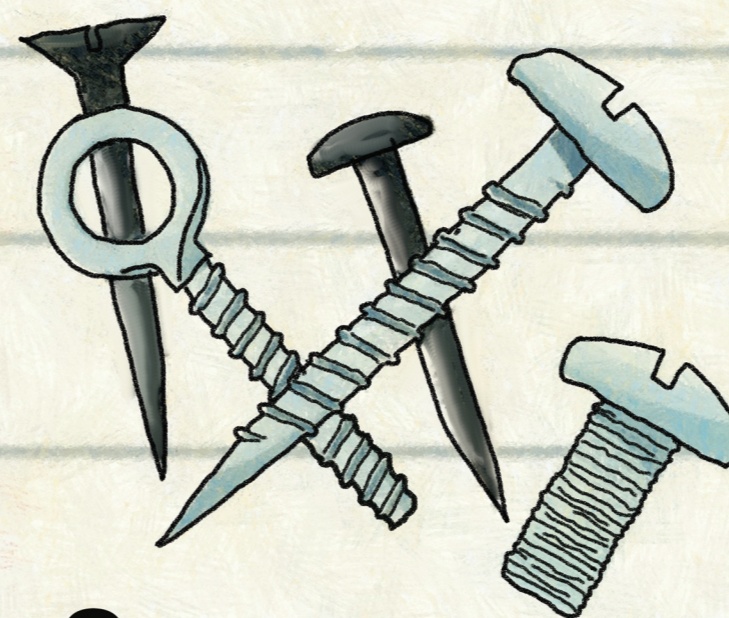









Screws and Nails

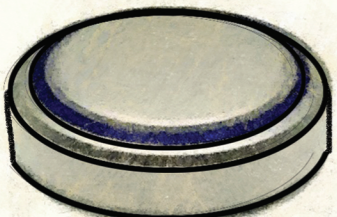

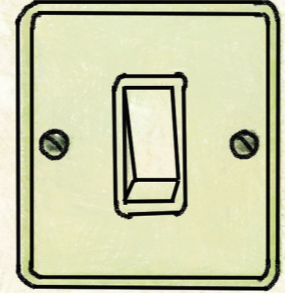
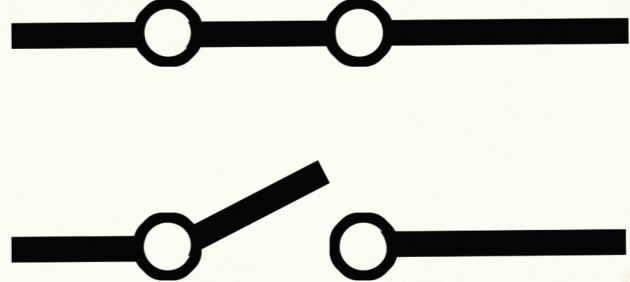
Aluminium Foil

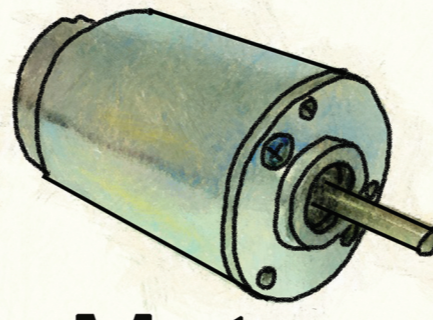
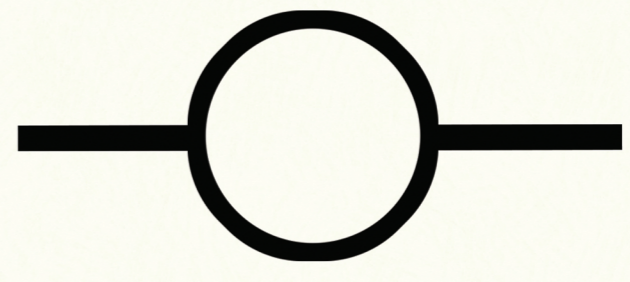
CIRCUIT SYMBOLS

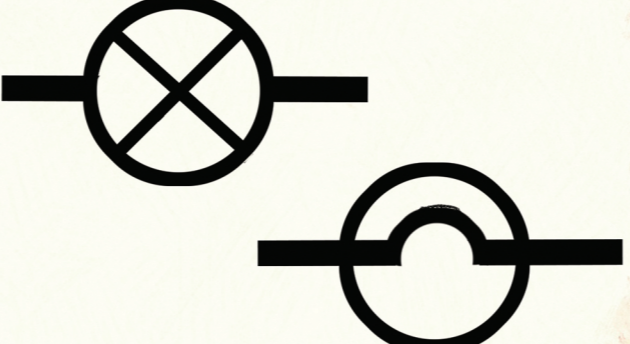
Here is a list of the most common symbols.

	A cell is a source of electrical energy.			A switch can be turned on (closed) to let current flow or turned off (open) to stop current flow.	
	A battery contains numerous cells connected so that they produce more electrical energy.			A motor turns current into motion, for example in a hairdryer.	
	A bulb will light up only when it is in a circuit that is complete.			A buzzer turns current into sound.	